

Pal fix mini

moedi **RPK**



Pal fix mini

model **RPK** PAT.P.

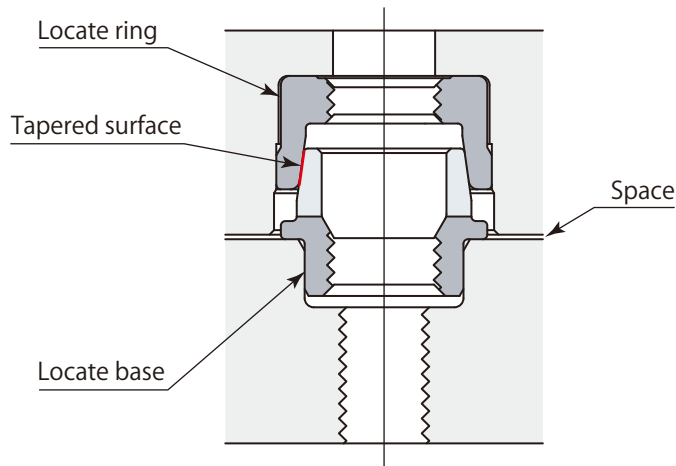
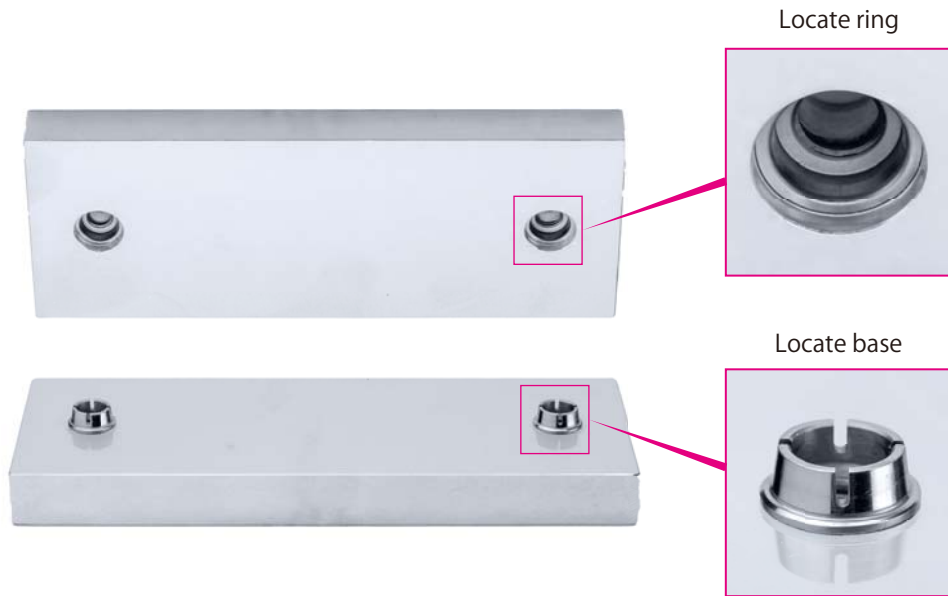

There is a clearance when the two sides are mated.

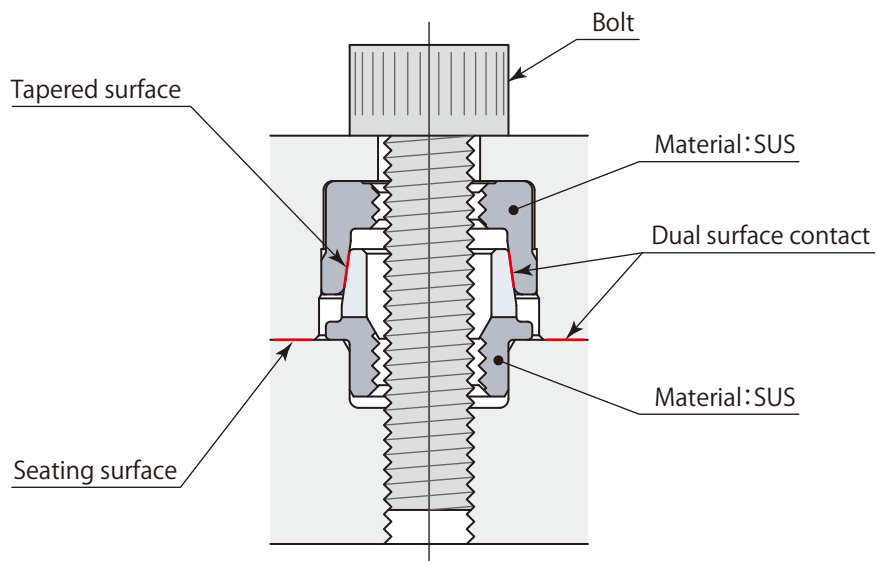

The locate ring and base surface will be completely flush once the screw is fastened.
Stainless steel has less deterioration over time due to elastic deformation.

Specifications

RPK – **A** : Locate base
N : Locate ring

Size

03
04
05

Model			RPK-□03	RPK-□04	RPK-□05
Repeatability		μ m	3		
Max. allowable load*1	Horizontal mounting	N	40	70	110
	Vertical mounting	N	8	14	22
Min. clamping force*2		N	400	700	1100
Mass	Locate base	g	0.7	1.1	1.4
	Locate ring	g	0.9	1.4	1.8

*1: This is the maximum allowable load for pallets, regardless of how many Pal fix units are used.
 *2: Indicates the necessary force to position one locate base and locate ring pair.



Dimensions

Locate ring

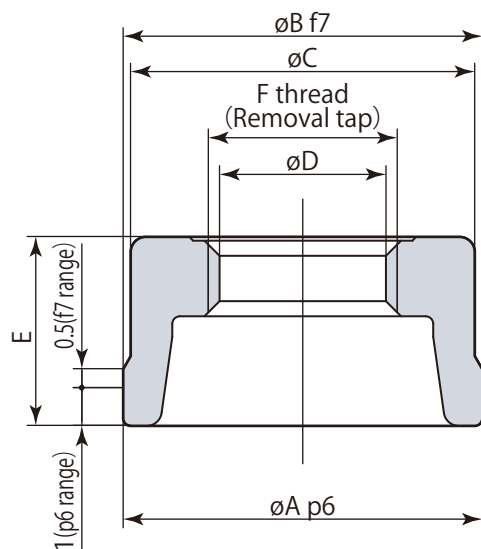

Model	RPK-N03	RPK-N04	RPK-N05
$\varnothing A$	$8^{+0.024}_{+0.015}$	$9.5^{+0.024}_{+0.015}$	$11^{+0.029}_{+0.018}$
$\varnothing B$	$8^{-0.013}_{-0.028}$	$9.5^{-0.013}_{-0.028}$	$11^{-0.016}_{-0.034}$
$\varnothing C$	7.6	9.1	10.6
$\varnothing D$	3.4	4.4	5.3
E	4.5	5	5
F	M4 x 0.7	M5 x 0.8	M6 x 1

Locate base

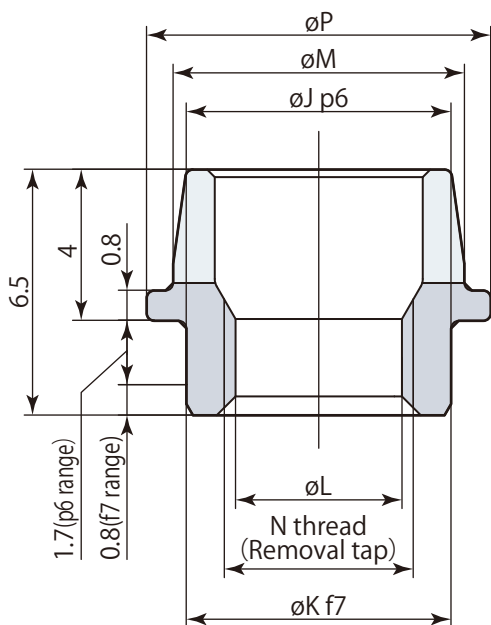

Model	RPK-A03	RPK-A04	RPK-A05
$\varnothing J$	$5.5^{+0.020}_{+0.012}$	$7^{+0.024}_{+0.015}$	$8^{+0.024}_{+0.015}$
$\varnothing K$	$5.5^{-0.010}_{-0.022}$	$7^{-0.013}_{-0.028}$	$8^{-0.013}_{-0.028}$
$\varnothing L$	3.4	4.4	5.3
$\varnothing M$	6.2	7.7	9.2
N	M4 x 0.7	M5 x 0.8	M6 x 1
$\varnothing P$	7.6	9.1	10.6

Mounting details

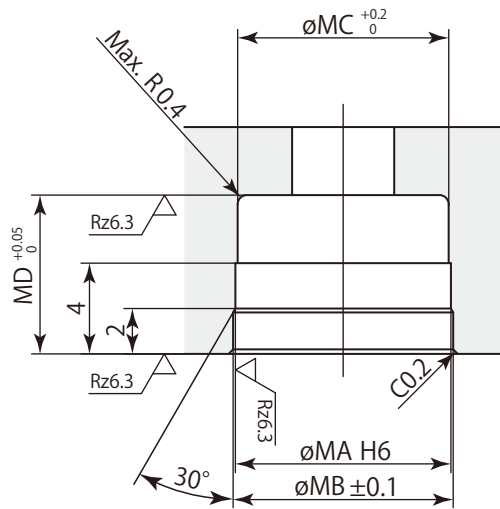

mm

Model	RPK-N03	RPK-N04	RPK-N05
øMA	8 ^{+0.009} ₀	9.5 ^{+0.009} ₀	11 ^{+0.011} ₀
øMB	8.2	9.7	11.2
øMC	7.8	9.3	10.8
MD	6.5	7	7

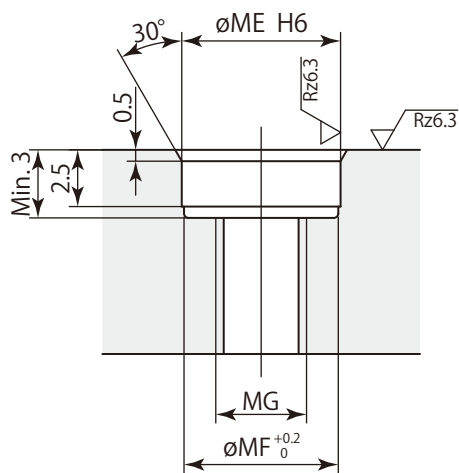

mm

Model	RPK-A03	RPK-A04	RPK-A05
øME	5.5 ^{+0.008} ₀	7 ^{+0.009} ₀	8 ^{+0.009} ₀
øMF	5.3	6.8	7.8
MG	M3	M4	M5

Mounting pitch tolerance

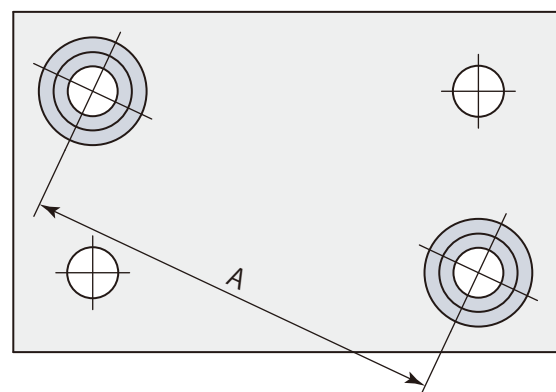
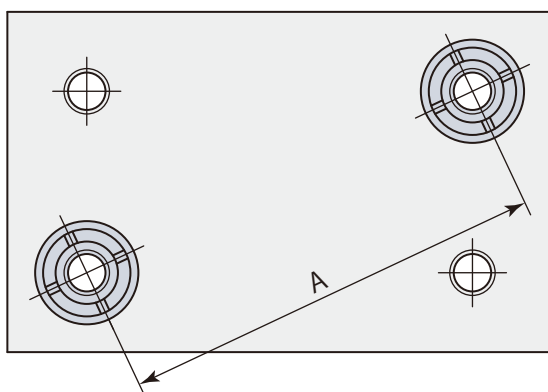

Pitch tolerance of A dimension : ±0.02mm

Mounting method

Press-fit the Pal fix as shown in the diagram below.

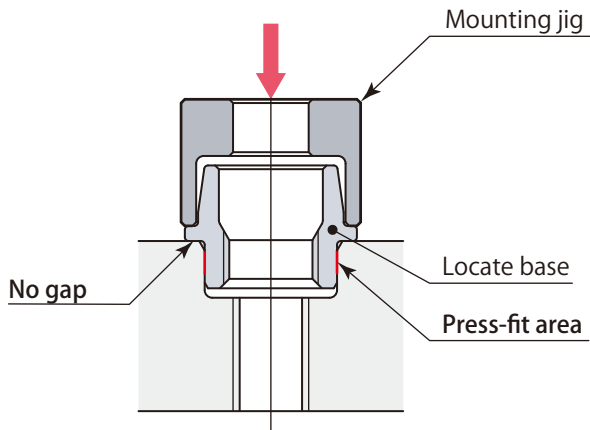

Mounting the locate base

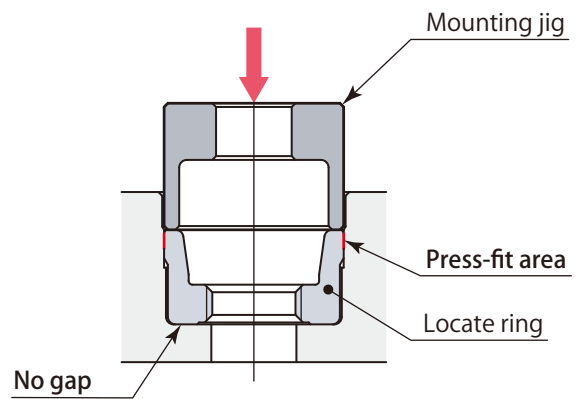

Mounting the locate ring

Mounting jig details

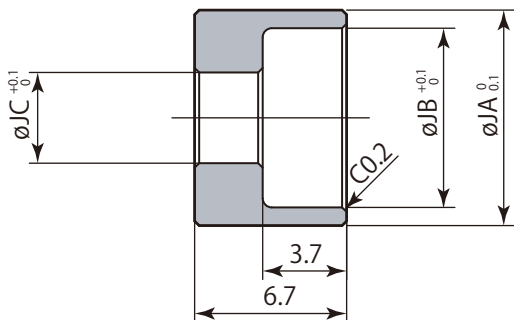

Model	RPK-□03	RPK-□04	RPK-□05
$\varnothing JA$	8	9.5	11
$\varnothing JB$	6.4	7.9	9.4
$\varnothing JC$	3	4	3

mm

Tightening order for the screw

Tighten the screw #1 and #2 first
 The position repeatability is ensured by tightening in the same order and with the same torque each time.

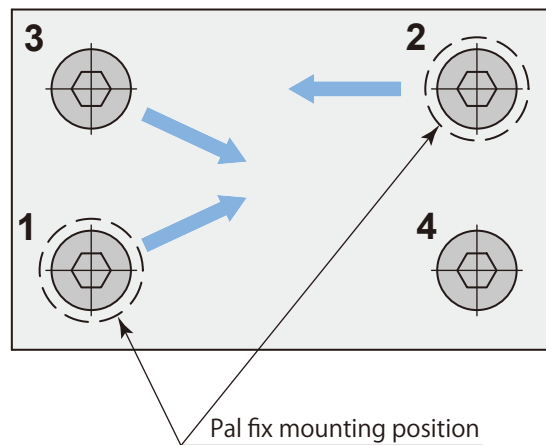

How to dismount the Pal fix

Remove the bolt with a puller.

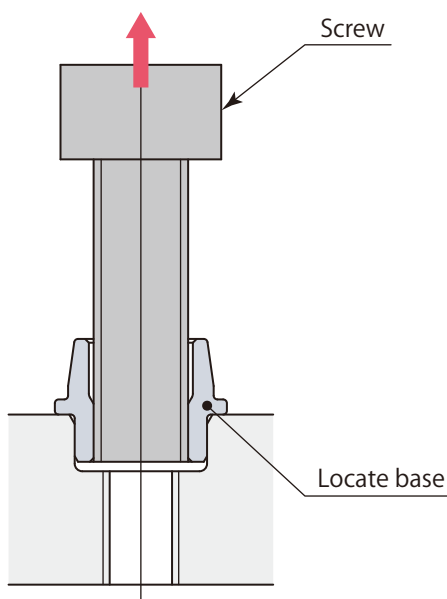

Dismounting the locate base

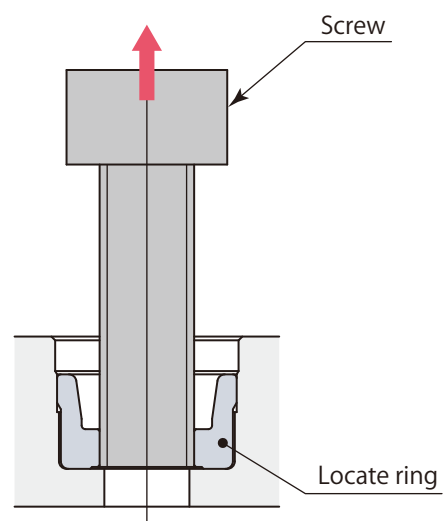

Dismounting the locate ring

Pascal

Itami, Hyogo, Japan 664-8502
TEL. 072-777-3333 FAX. 072-777-3520



CERTIFICATE OF APPROVAL ISO9001