

Single rotary with flange 25MPa

model WRA□F



Single rotary with flange is a compact type rotary joint with mounting section of the body shaped in the form of flange to keep the overall height low. Four types are available with 2 to 8 circuits, and each circuit can be used independently.

Fluid should be supplied from flange side of the body with manifold piping.

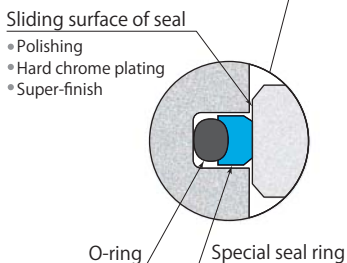
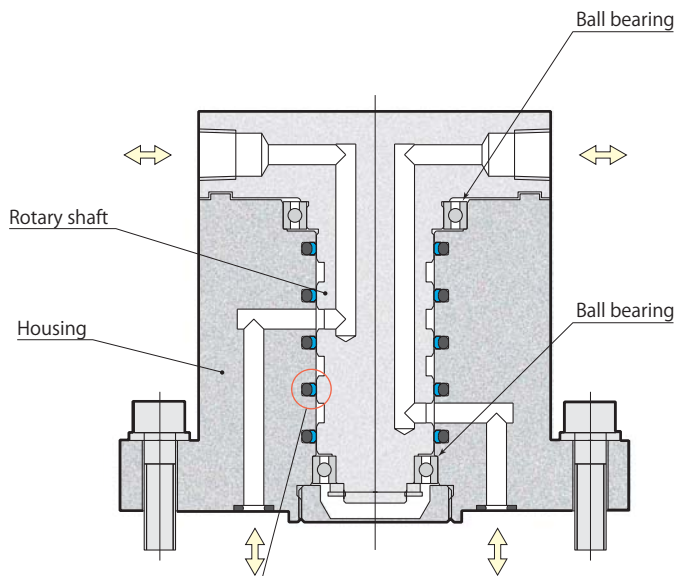

Sliding surface is polished, hard chrome plated and then super-finished to offer superior seal performance and durability.

2 circuits

WRA2F

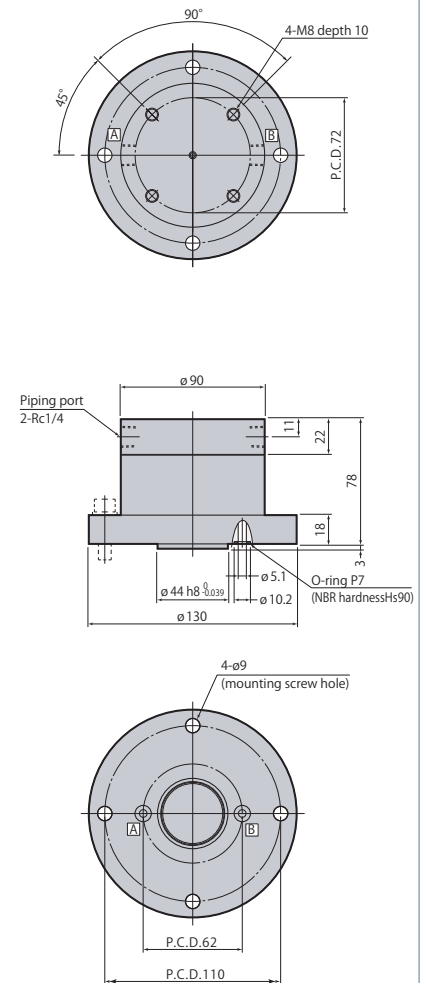

Each piping port is marked with code A or B. The mounting surface finish must be no rougher than Rz6.3 (ISO4287:1997).

Specifications

Model	WRA2F	WRA4F	WRA6F	WRA8F
Number of circuits	2 circuits	4 circuits	6 circuits	8 circuits
Orifice area mm ²	20.4			
Fluid used	General mineral based hydraulic oil (ISO-VG32 equivalent) or air			
Max. pressure MPa	25			
Allowable rotations	Varies depending on fluid pressure (refer to page →246 for details on allowable rotations.)			
Operating temperature °C	0-70			
Piping port size	Rc1/4 (body lower surface is manifold piping)			
Mass kg	4.9	6.1	10.9	14.9

4 circuits

WRA4F

Each piping port is marked with code A through D. The mounting surface finish must be no rougher than Rz6.3 (ISO4287:1997).

6 circuits

WRA6F

Each piping port is marked with code A through F. The mounting surface finish must be no rougher than Rz6.3 (ISO4287:1997).

8 circuits

WRA8F

Each piping port is marked with code A through H. The mounting surface finish must be no rougher than Rz6.3 (ISO4287:1997).

● Mounting screws are not included.